

229

233

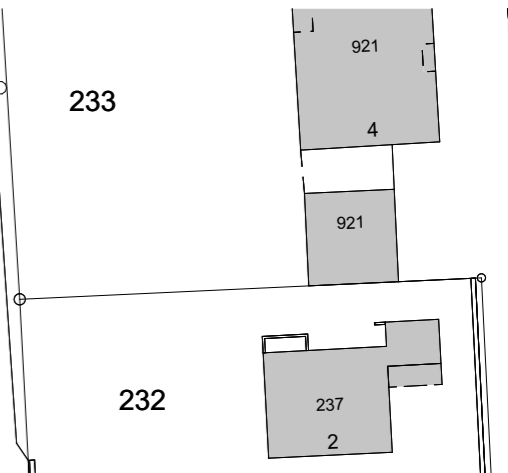
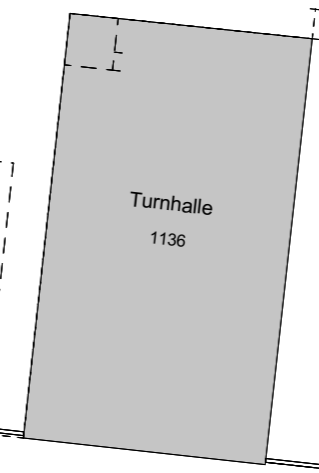
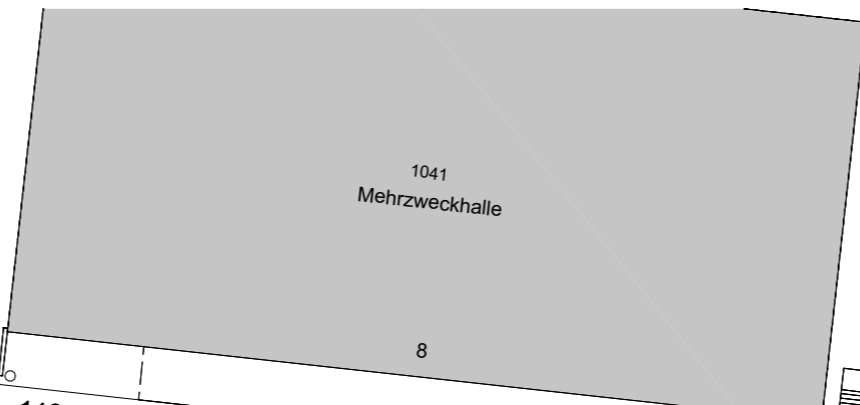
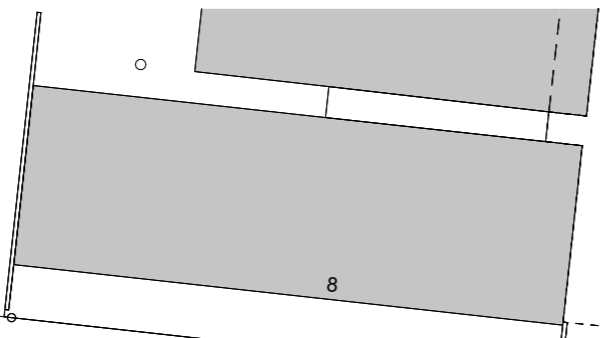

Rüslersstrasse

1106

2352

2351

2350

2277

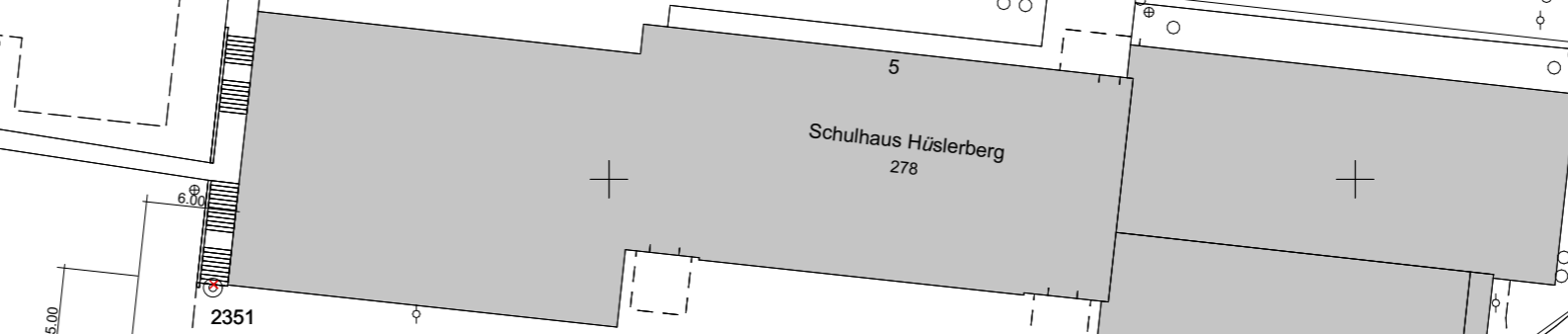

238

Hüslersberg

242

Pausenplatz, Kies

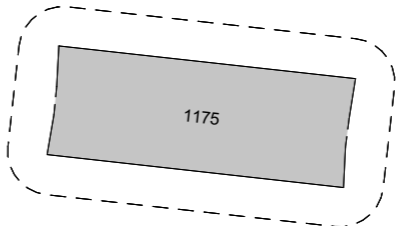

241

1187

820

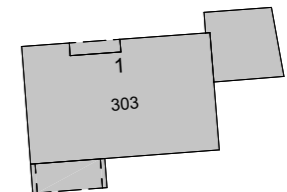

239

455

1066

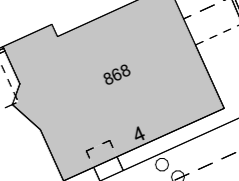

Daviacherweg

P001 Schulhausprovisorium | Niederrohrdorf

Standort Parzellennummer 242 | Schulhaus Rüslers | 5443 Niederrohrdorf
Bauherr Kreisschulverband Rohrdorferberg, c/o Bauverwaltung Niederrohrdorf
Architekt Bele Architekten + Partner GmbH | Oberdorfstrasse 1 | 5443 Niederrohrdorf
T 056 485 70 40 | info@belearchitekten.ch | www.belearchitekten.ch
Plandaten Plannummer 340-01 | Plotdatum 20.04.2021 | Format A3 | Gezeichnet SS

BP Situation 1:500